

NOTE
ALL DIMENSIONS TO BE CHECKED ON SITE
NO DIMENSIONS TO BE SCALED FROM THIS DRAWING
THIS DRAWING IS TO BE READ IN CONJUNCTION WITH
RELEVANT CONSULTANTS DRAWINGS

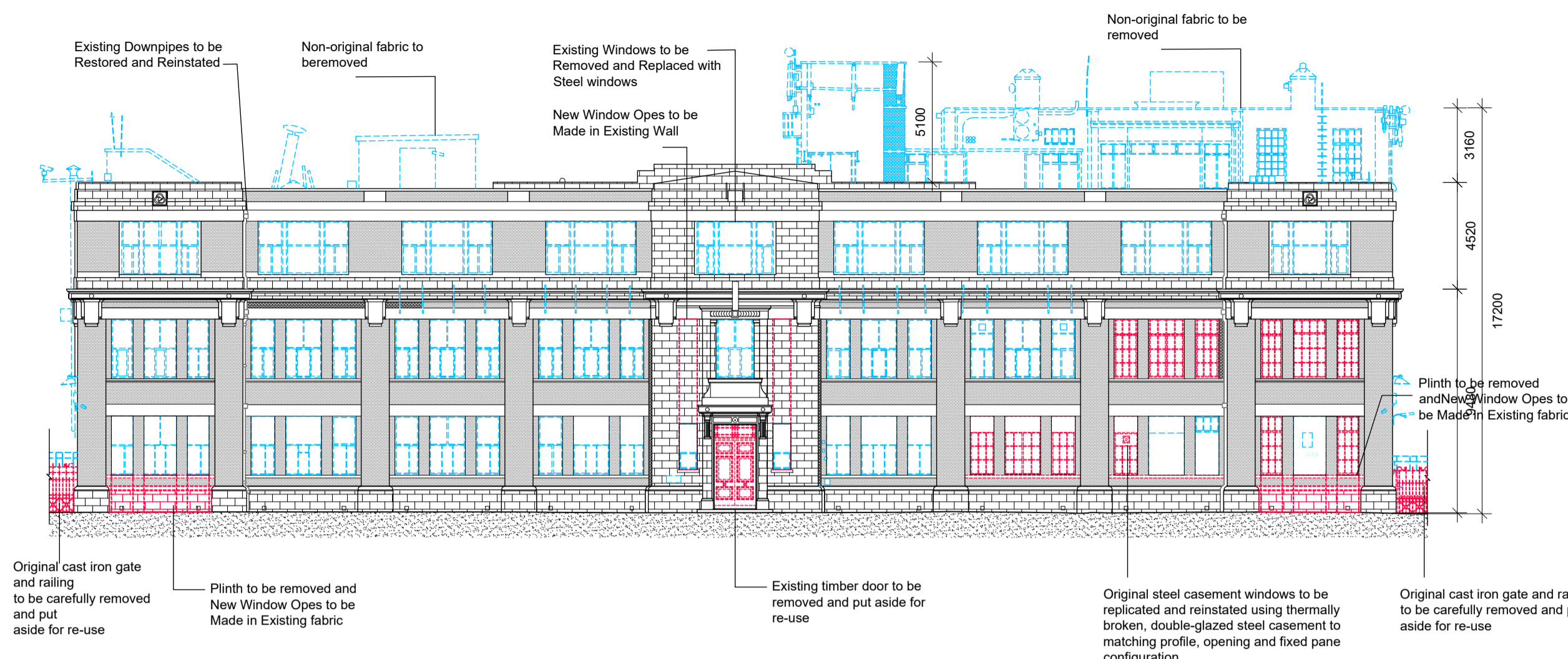

01 SOUTH ELEVATION OF PLAYER WILLS FACTORY
PL0200 SCALE 1:200

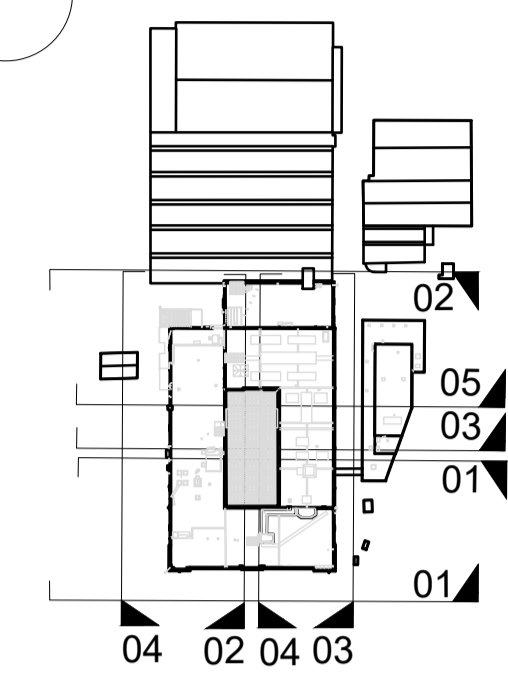
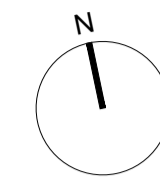
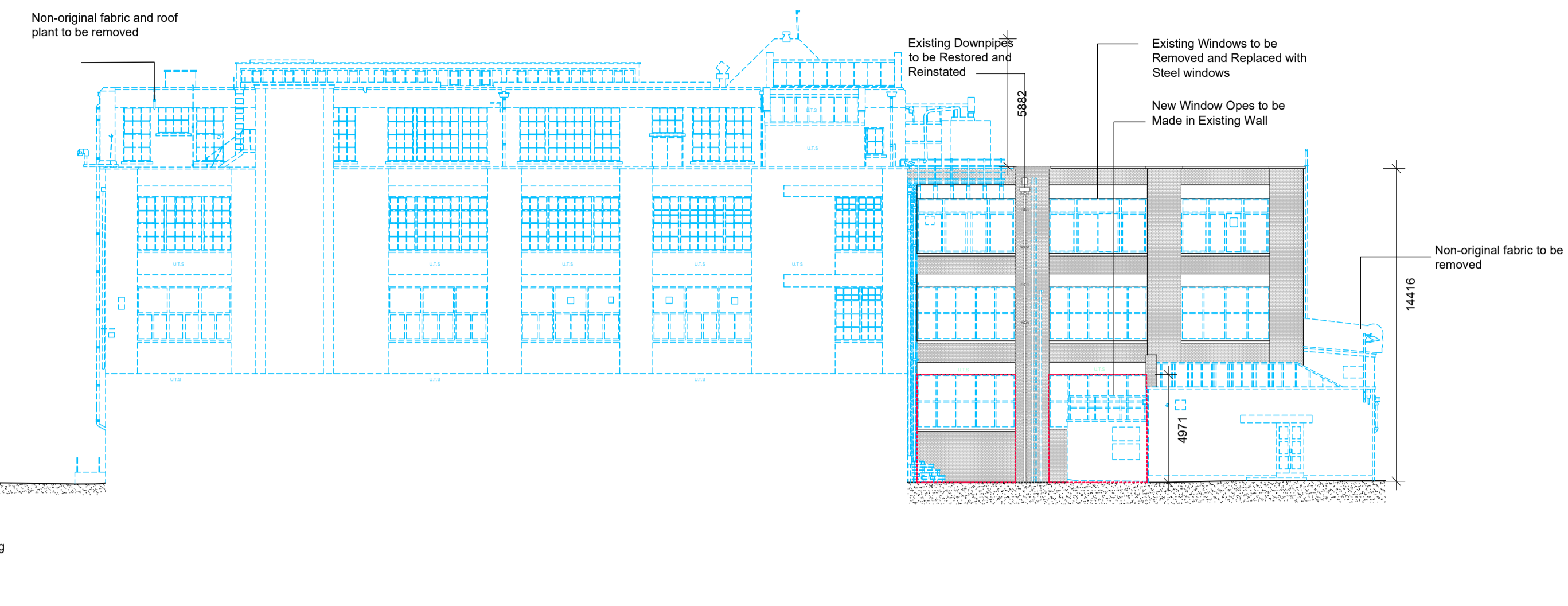

02 NORTH ELEVATION OF PLAYER WILLS FACTORY
PL0200 SCALE 1:200

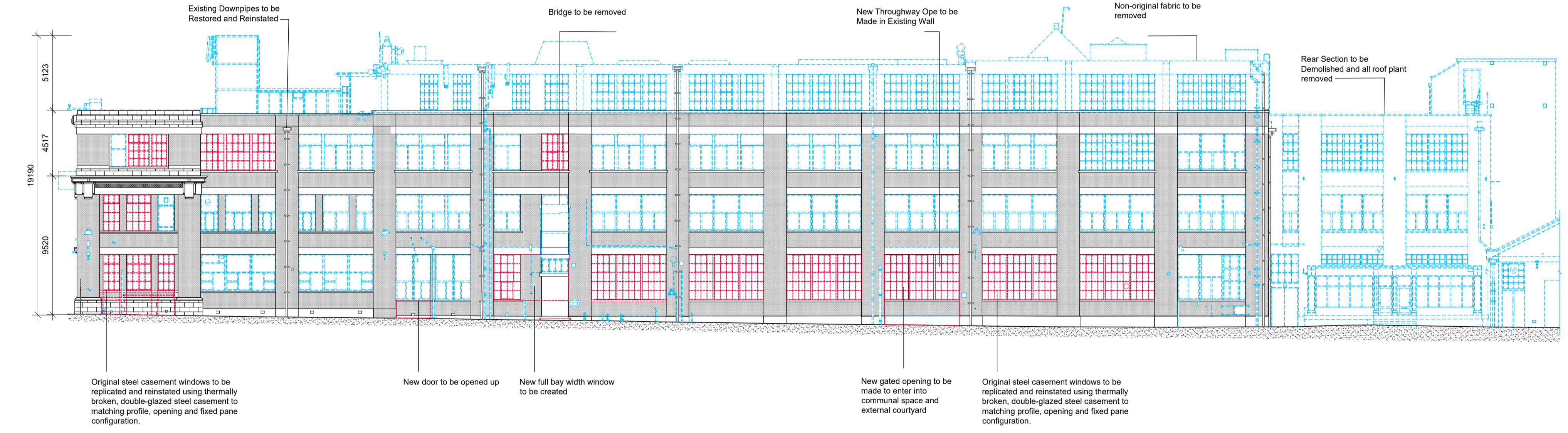

03 EAST ELEVATION OF PLAYER WILLS FACTORY
PL0200 SCALE 1:200

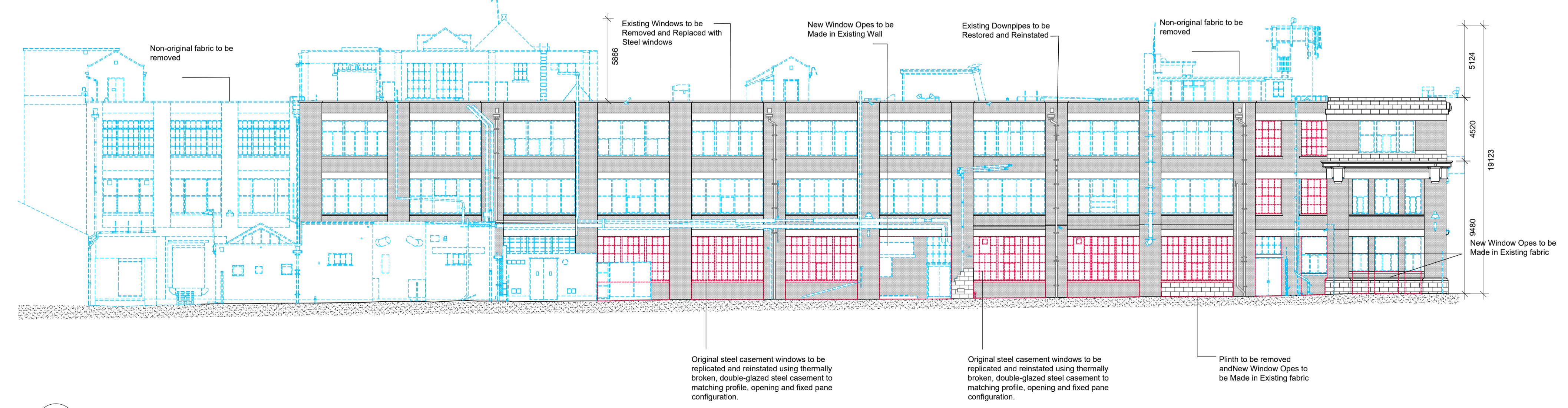

04 WEST ELEVATION OF PLAYER WILLS FACTORY
PL0200 SCALE 1:200

DEMOLITION LEGEND

- ORIGINAL FABRIC PROPOSED FOR REMOVAL**
Structural fabric from the original 1924 Factory proposed for careful removal in accordance with conservation specifications
- NON-ORIGINAL FABRIC PROPOSED FOR REMOVAL**
- NON-LOAD BEARING WALLS AND DOORS PROPOSED FOR REMOVAL**
- ORIGINAL FABRIC PROPOSED FOR REMOVAL**
Structural slabs required to be removed to allow for new structures to be constructed or new slab to be in-filled.
- Structure to be retained**

REV	DATE	DESCRIPTION	BY	AR
A	DEC 2020	ISSUED FOR PLANNING	BF	AR
CHWD			DRN	

PLANNING

Henry J Lyons

Architecture + Interiors +353 1 888 3333 51-54 Pearse Street
henryjlyons.com info@henryjlyons.com Dublin D02 KA66



CLIENT
DBTR-SCR1 Fund

PROJECT
SHD on the former Player Wills Site and Dublin City Council Lands at South Circular Road, Dublin 8

JOB NUMBER:	950578
DATE:	MARCH 2020
SCALE:	1:200 @A1
DRAWN:	RMD
CHECKED:	BF
FILE NAME:	950578 X- PL0100 PW_Demolitions

DRAWING
PW1 DEMOLITION
ELEVATIONS
SHEET 1 OF 2

BLOCK	DRAWING NUMBER	ZONE	REVISION
	PL0200		A